

INOVASTA TOPCOAT ROOF SYSTEM FOR ASPHALT (BITUMEN) ROOFS SYSTEM RF301

10 YEARS
GUARANTEE

1 TOPCOAT ROOF SYSTEMS FOR ASPHALT (BITUMEN) ROOFS	
PRODUCTS	SYSTEM RF 301
	10 YEARS GUARANTEE
2 ROOFPRIME	0,8 lt / m2
3 JOINTFABRIC	1,0 m2/m2
4 JOINTFILL (Sealing areas)	2,0 kg / m2
5 ROOFCOAT	1,8 lt / m2
6 TOPCOAT	0,6 lt / m2
7 PENETCOAT (OPTIONAL)	0,3 lt / m2
MATERIALS REQUIRED PER 1 M2	

APPLICATION DRAWING

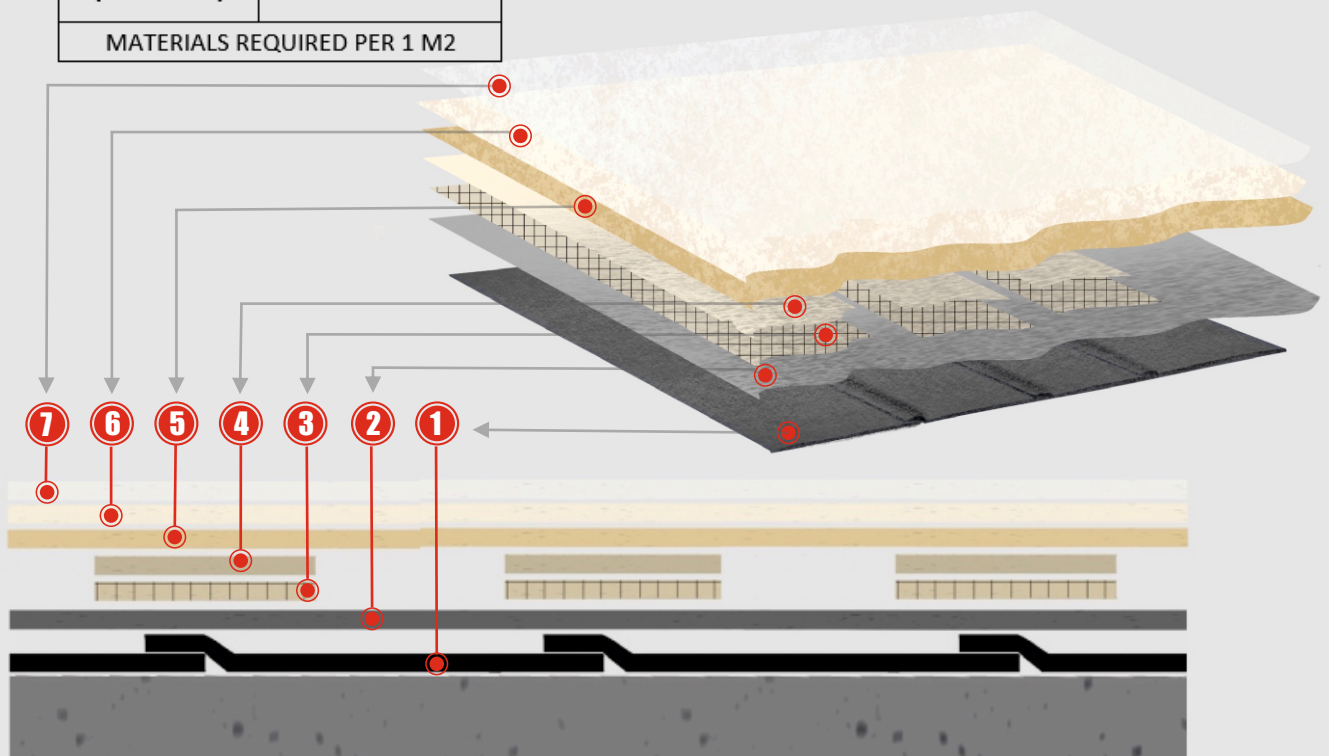
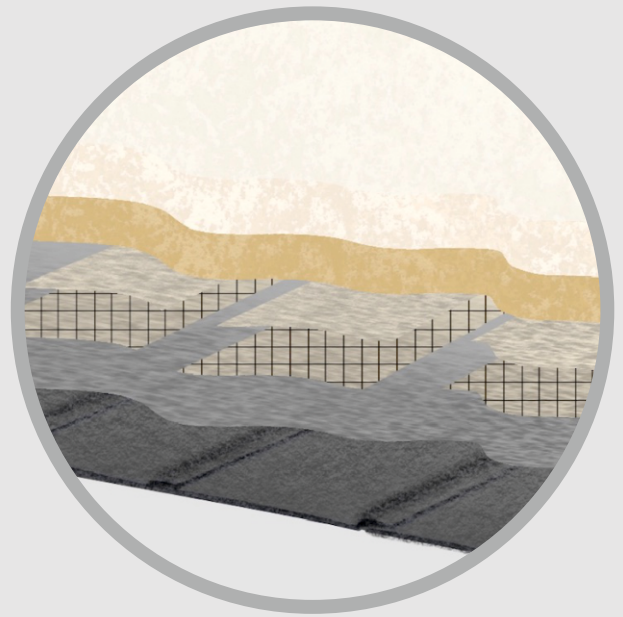

INOVASTA TOPCOAT ROOF SYSTEM FOR ASPHALT (BITUMEN) ROOFS SYSTEM RF302

10 YEARS
GUARANTEE

1 TOPCOAT ROOF SYSTEMS FOR ASPHALT (BITUMEN) ROOFS	
PRODUCTS	SYSTEM RF 302
	10 YEARS GUARANTEE
2 ROOFPRIME	0,8 lt / m2
3 JOINTFABRIC	1,0 m2/m2
4 JOINTFILL	2,5 kg / m2
5 TOPCOAT	0,6 lt / m2
6 PENETCOAT (OPTIONAL)	0,3 lt / m2
MATERIALS REQUIRED PER 1 M2	

APPLICATION DRAWING

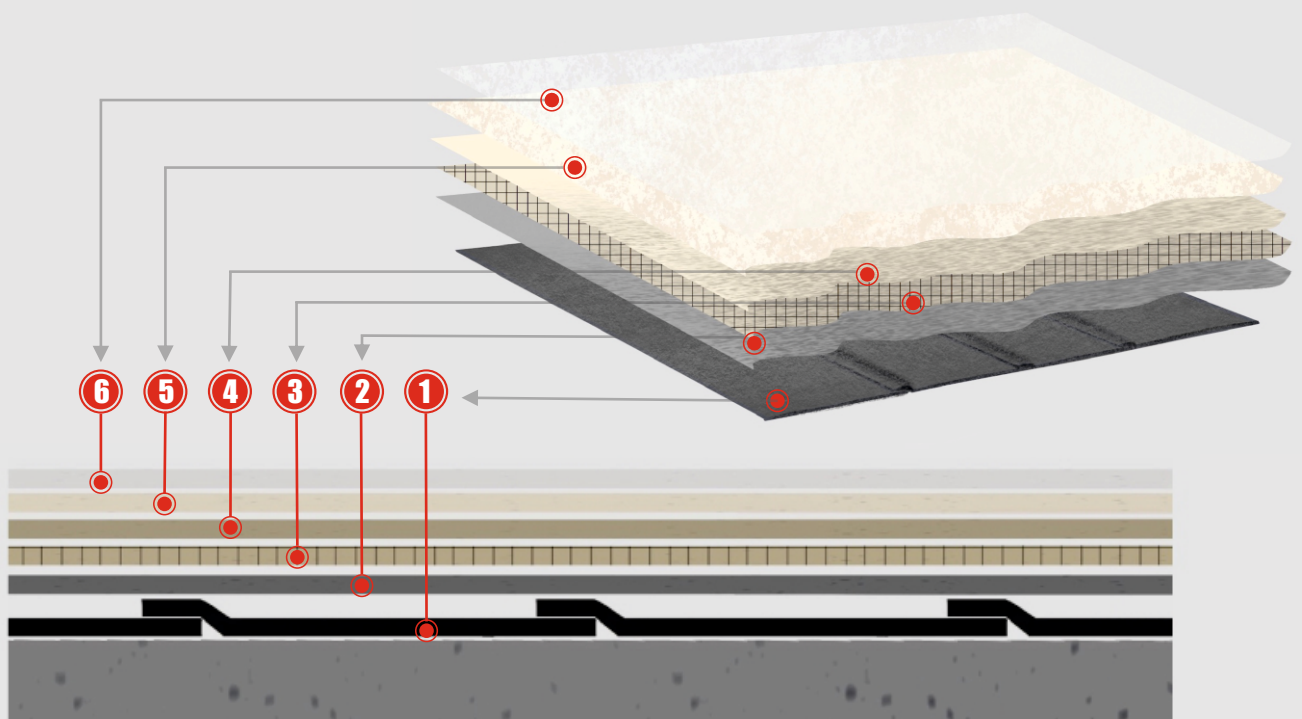
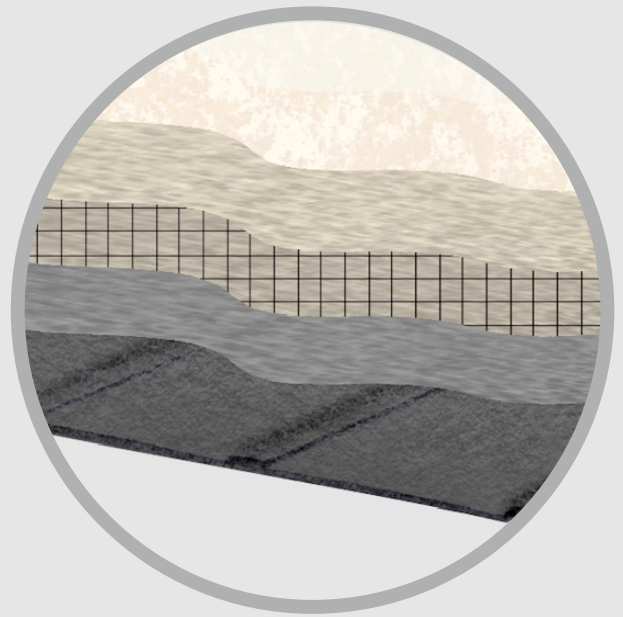

INOVASTA TOPCOAT ROOF SYSTEM FOR ASPHALT (BITUMEN) ROOFS SYSTEM RF303

5 YEARS
GUARANTEE

1 TOPCOAT ROOF SYSTEMS FOR ASPHALT (BITUMEN) ROOFS	
PRODUCTS	SYSTEM RF 303
2 ROOFPRIME	0,8 lt / m2
3 JOINTFABRIC	1,0 m2/m2
4 JOINTFILL (Sealing areas)	2,5 kg / m2
5 TOPCOAT	1,0 lt / m2
6 PENETCOAT (OPTIONAL)	0,3 lt / m2
MATERIALS REQUIRED PER 1 M2	

APPLICATION DRAWING

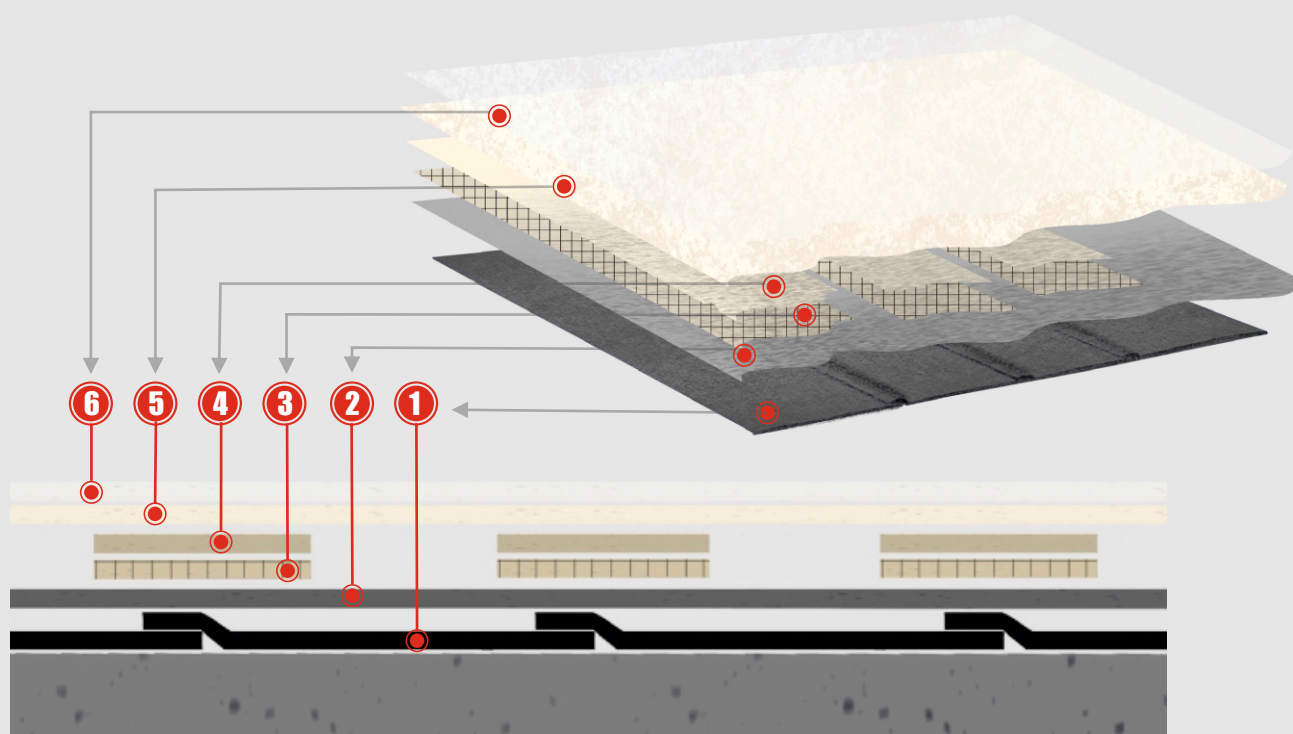
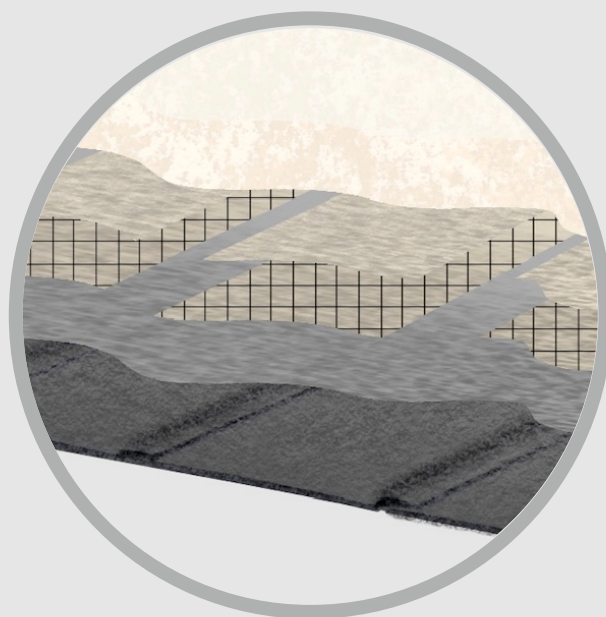

INOVASTA TOPCOAT ROOF SYSTEM FOR ASPHALT (BITUMEN) ROOFS SYSTEM RF304

2 YEARS
GUARANTEE

1

TOPCOAT ROOF SYSTEMS FOR ASPHALT (BITUMEN) ROOFS

PRODUCTS	SYSTEM RF 304
ROOFPRIME	0,8 lt/ m2
JOINTFABRIC	1,0 m2/m2
JOINTFILL (Sealing areas)	2,5 kg / m2
MATERIALS REQUIRED PER 1 M2	

2

3

4

APPLICATION DRAWING

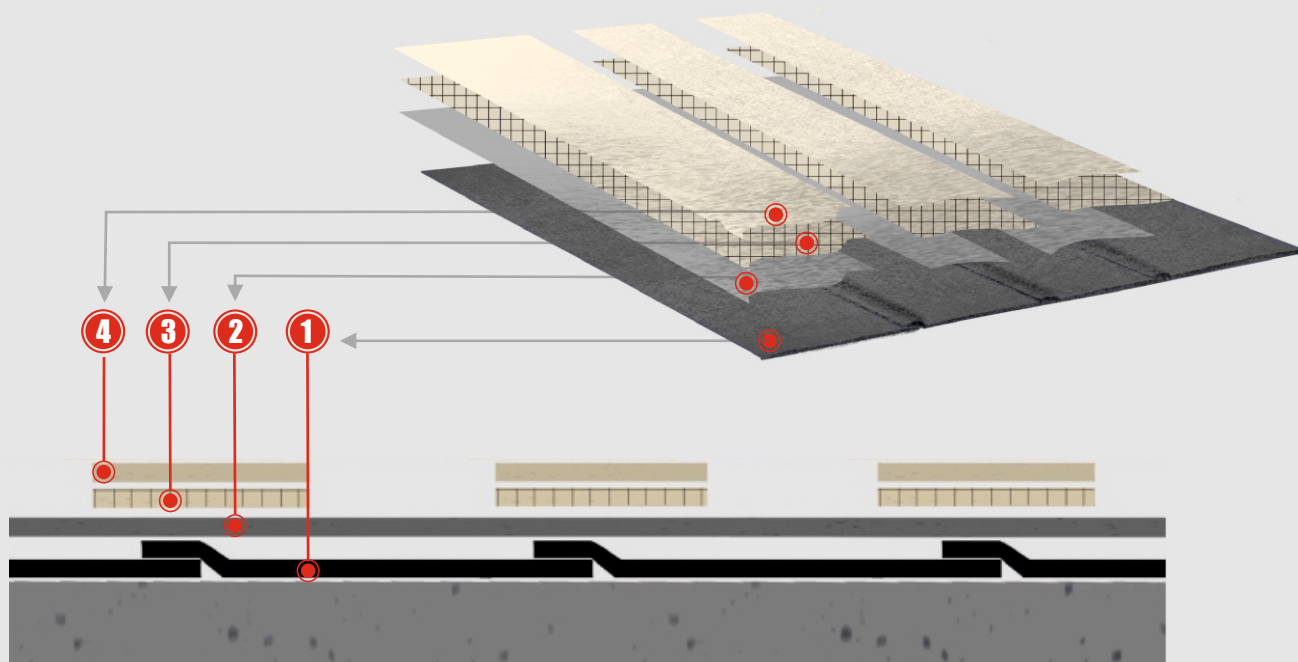
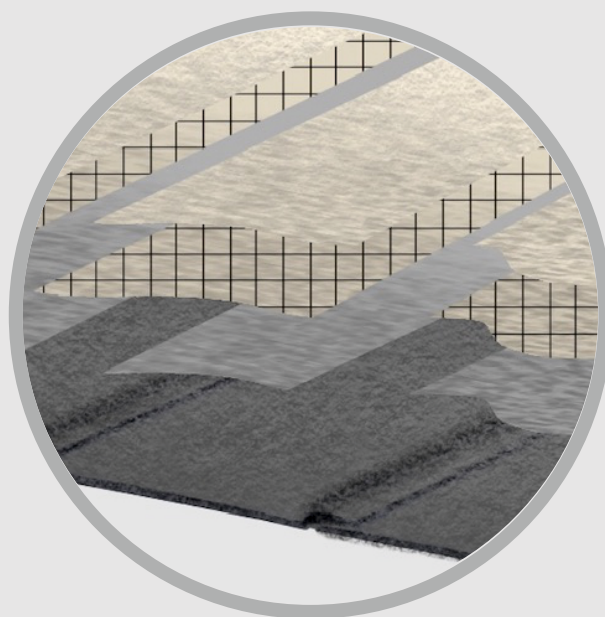



INOVASTA TOPCOAT ROOF SYSTEM FOR ASPHALT (BITUMEN) ROOFS

APPLICATION INSTRUCTION

Proper preparation of the surface to be treated is an extremely important first step to successful performance. The following preparation must be performed before beginning installation:

The roof surface must be in generally sound condition. Do not apply a INOVASTA Topcoat System to an asphalt roof if the roof has been previously "cap sheeted" or if it has more than one built-up roof. Leaks must be well defined and correctable through normal patching procedures outlined below. If the asphalt surface has widespread embrittlement, or if leaks are not attributable to specific and correctable causes, do not proceed with installation. In addition, asphalt roofs that exhibit either existing or previously repaired long, straight, directional cracks or splitting through the entire thickness of the existing waterproofing membrane (commonly at laps in the roofing felts) can be maintained with a INOVASTA Topcoat System. Such a chase Please contact with INOVASTA headquarters to get an advice.

Insulation, if any, must be dry. The roof surface should drain water freely. Because standing water accelerates deterioration of all asphalt roofing products, every effort should be made to isolate and correct the causes of any standing or ponding water on the roof.

STEP # 1 PREPARE THE ROOF SURFACE

CLEANING and PRIMING the ROOF

- Smooth Surface or mineral Asphalt Roofs - The old surface must be thoroughly cleaned and must be free from all dust, dirt and loose debris. This is absolutely necessary for proper performance of INOVASTA Topcoat Roof Systems. On extremely dirty roofs, it is advisable to flush the surface with water, allowing the surface to dry thoroughly before proceeding with roofing work.
- Physical problems of the membranes such as open seams, waving, ballooning, and leveling has to be corrected.
- The tears in the metal foot bottoms will be corrected.
- Corrections will be made in areas with water or pots on the ground.
- Minerals over the Membranes will be cleaned with a hard brush. All kinds of dirt, mud, dust and other materials must be removed from the surface.
- For the all 4 SYSTEMS whole roof has to be primed by ROOFPRIME with a ratio of 0,8 lt / m². For SYSTEM RF 304, only the patching areas will be primed. It will be cured in 2 hours in hot weather.
- The product can also be sprayed with a spray machine, but it is also useful to apply it with a hard brush to better penetrate the surface.



INOVASTA TOPCOAT ROOF SYSTEM FOR ASPHALT (BITUMEN) ROOFS

STEP # 2

SEAL THE FLASHINGS

PATCH AND REPAIR WORKS

- Two materials will be used in the patch and repair process. JOINTFILL (Water-based, flexible and highly adhesive joint Patch and Filler) and JOINTFABRIC (Special glass fiber mesh)
- The list of areas to be patched and repaired are as follows.
- Repair all blisters, deep cracks, split seams and other irregular problems with JOINTFILL and JOINTFABRIC.
- Edge of wall, skylight, pitch pan, vent pipe and other equipment has to be patch by JOINTFILL and JOINTFABRIC.
- The patching process will be done in two layers with JOINTFILL and JOINTFABRIC.
- The width of the JOINTFABRIC will change according to the application area. All of the gutter surfaces will be applied with JOINTFABRIC. Membranes overlaps will be applied with 10 cm mesh. Wall and surface areas JOINTFABRIC application will be minimum 30 cm. JOINTFABRIC application will change according to the size of the problem.
- The application of JOINTFILL will be an average of 2.5 Kg / m². JOINTFILL will be cured in 12 hours depending on the weather.

STEP # 3

COAT THE ROOF

COATING AND FINISHING WORKS

- Immediately after the patch process, ROOFCOAT will be covered over the entire surface due to the purpose of completing the insulation and creating a seamless roof. The application will be made as 1.8 lt / m². This coating is included in all surfaces and parapets.
- As the last layer, TOPCOAT will be applied with a ratio of 0.6 lt / m². TOPCOAT will ensure additional reflection and protection from external factors. TOPCOAT will also provide a reflection of about 10 degrees of sun rays.
- Note that SYSTEMS RF 302, RF 303 and RF 304 ROOFCOAT will not be used.